

Camp Sunnystones Light Guide

Table of Contents:

Floor Plan	2
Dining Hall Lights.....	3
Dining Hall Fans.....	6
Pit Lights.....	7
Kitchen Lights.....	8
Game Room Lights.....	16
Courtyard Fairy Lights	18
Laundry Lights	20
Entrance Veranda Fluorescent Lights	22
Carpark Veranda Floodlights.....	24

Floor Plan

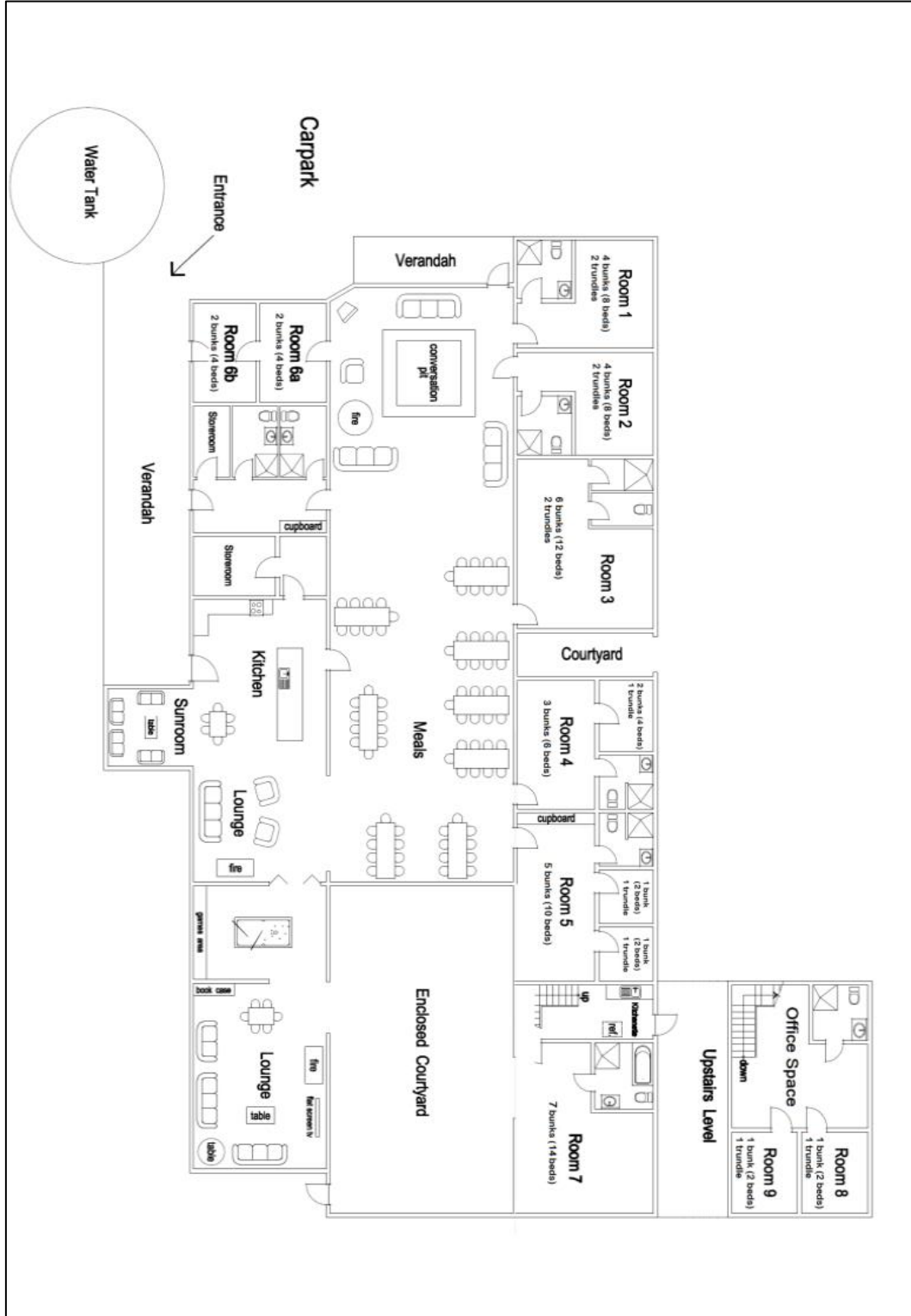

Dining Hall Lights

Main Fluorescent Lights:

Opposite fireplace, wooden pillar beside white drainpipe



Fairy Lights (power switch):

Opposite fireplace, wooden pillar beside white drain pipe



Wall Lights (both sides of dining hall):

On door frame behind the kitchen door

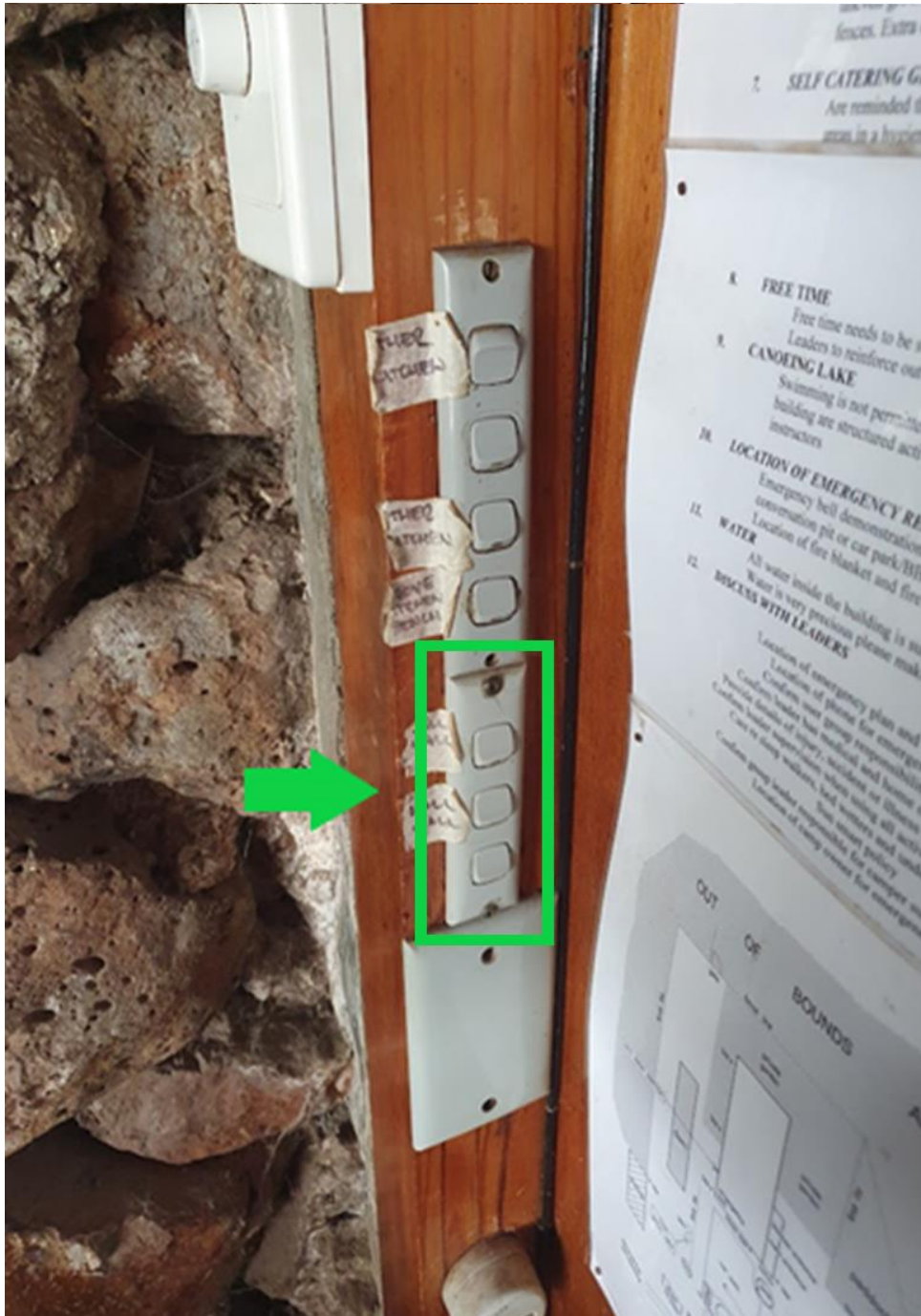

Dining Hall Fans

Ceiling Fans:

On door frame behind the kitchen door



Pit Lights

Ceiling Lights:

On wall in between rooms 1 and 2



Kitchen Lights

Down Lights (near kitchen sink/benches):

On door frame behind the kitchen door

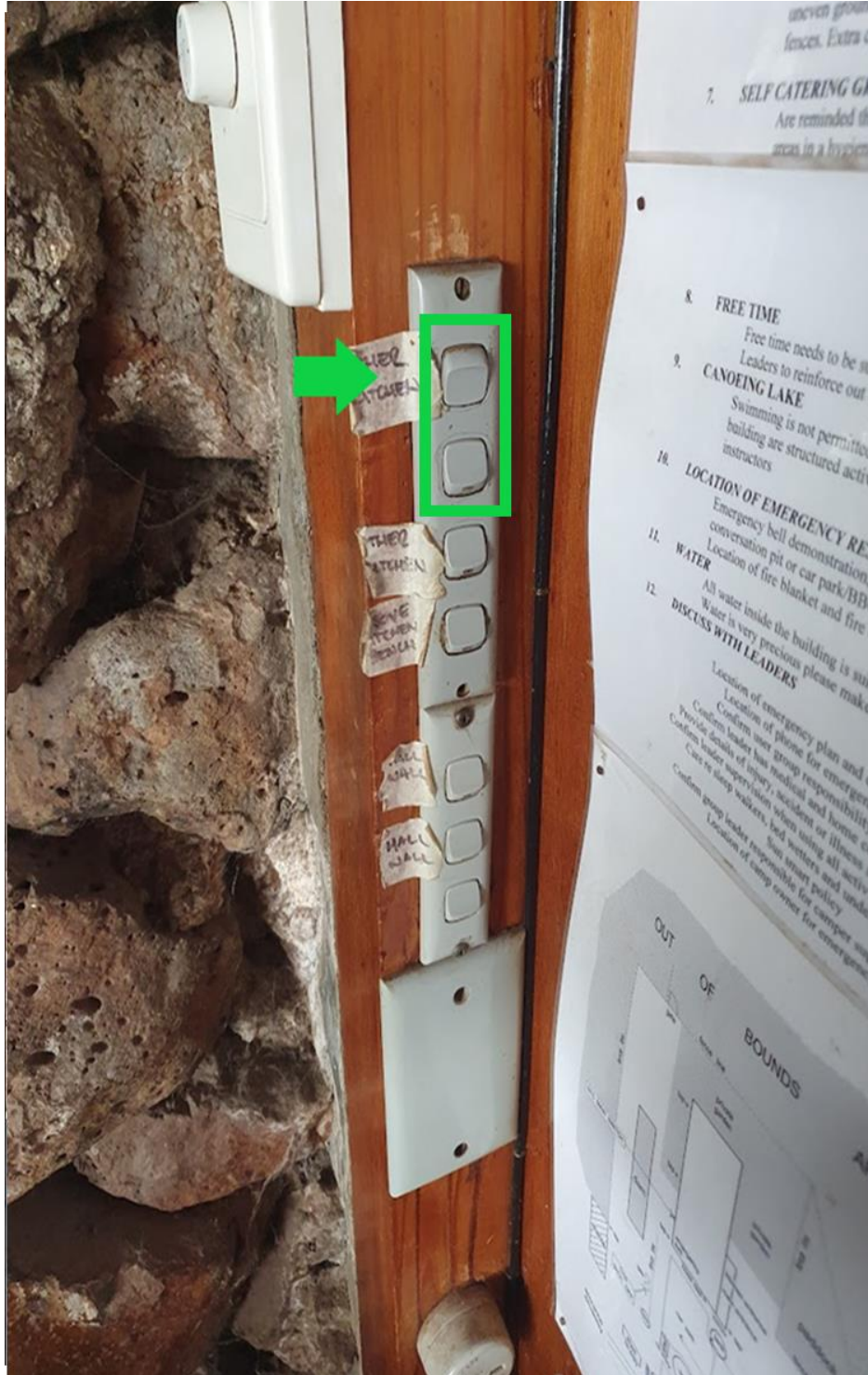

Fluorescent Lights (near kitchen sink/benches):

On door frame behind the kitchen door

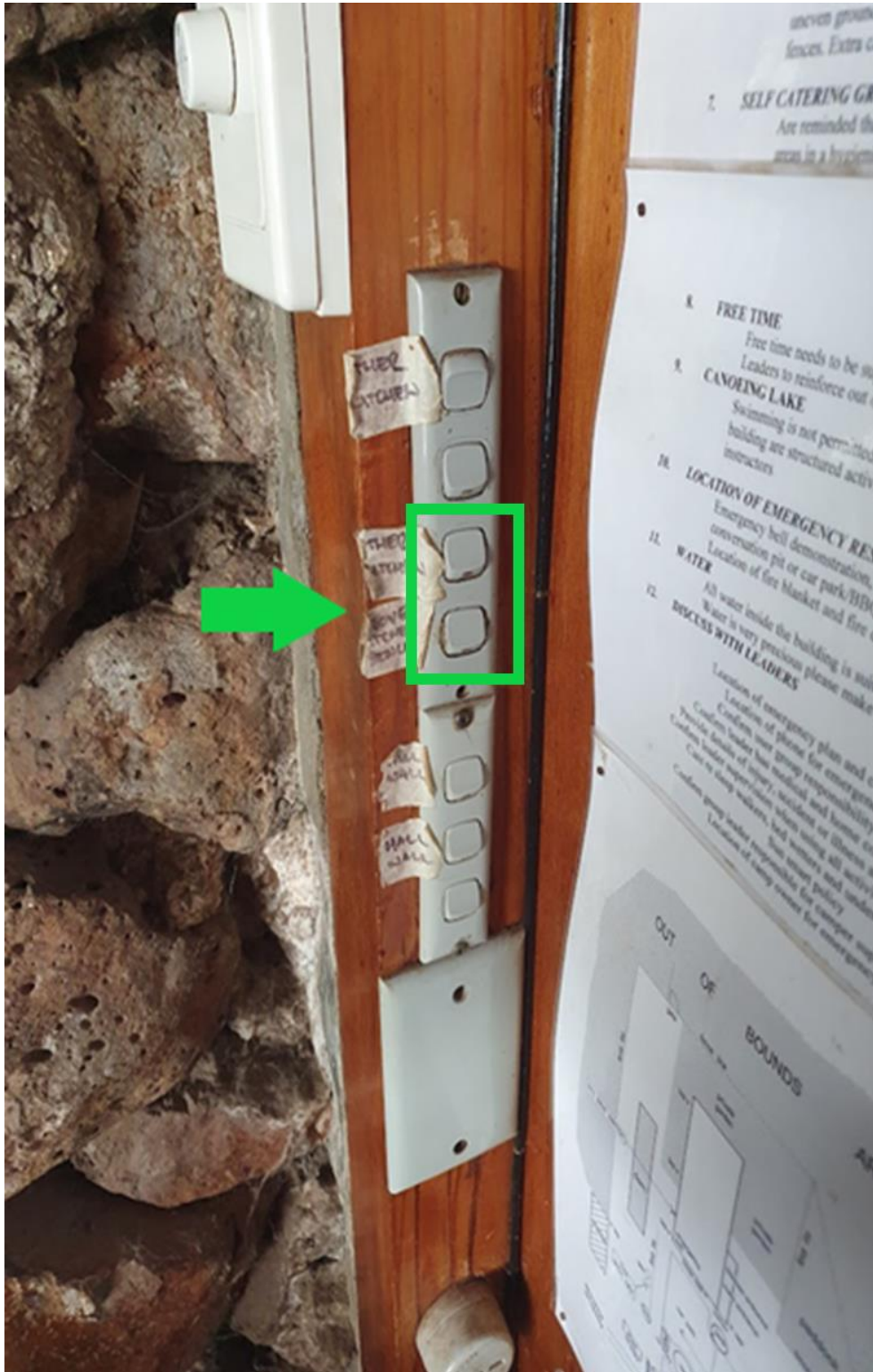

Kitchen Fireplace Down Lights:

On kitchen sliding door frame



Kitchen Fireplace Storeroom Lights (behind the fireplace in kitchen):

Middle switch on door frame beside bifold doors; located at entrance to game room



Kitchen Fridge/Freezer Room Lights:

On door frame of fridge/freezer room



Kitchen Pantry Lights:

On door frame of pantry entry



Kitchen Stovetop Lights:

On the left of kitchen cooking stove

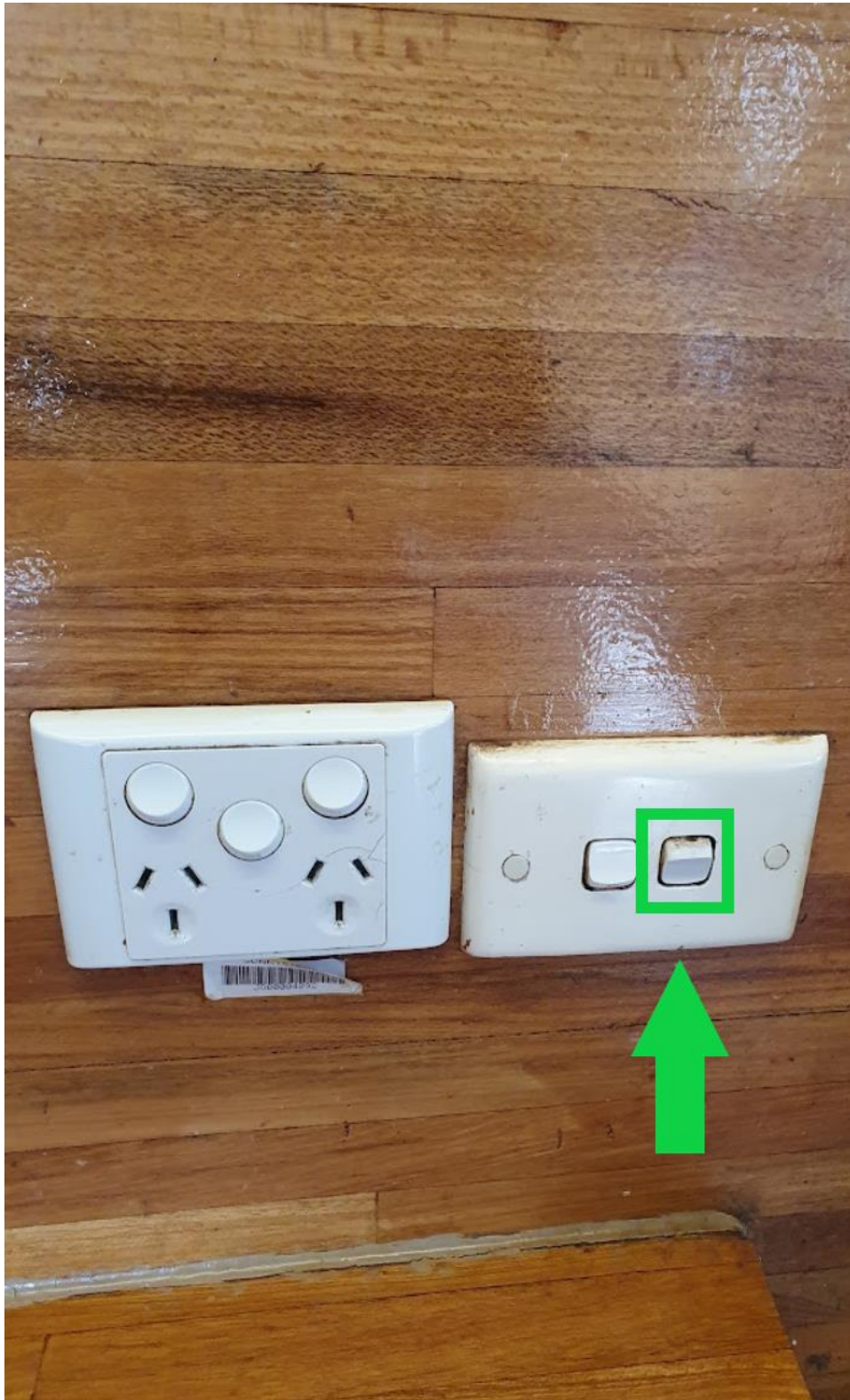

Kitchen Stovetop Fan:

On the left of kitchen cooking stove

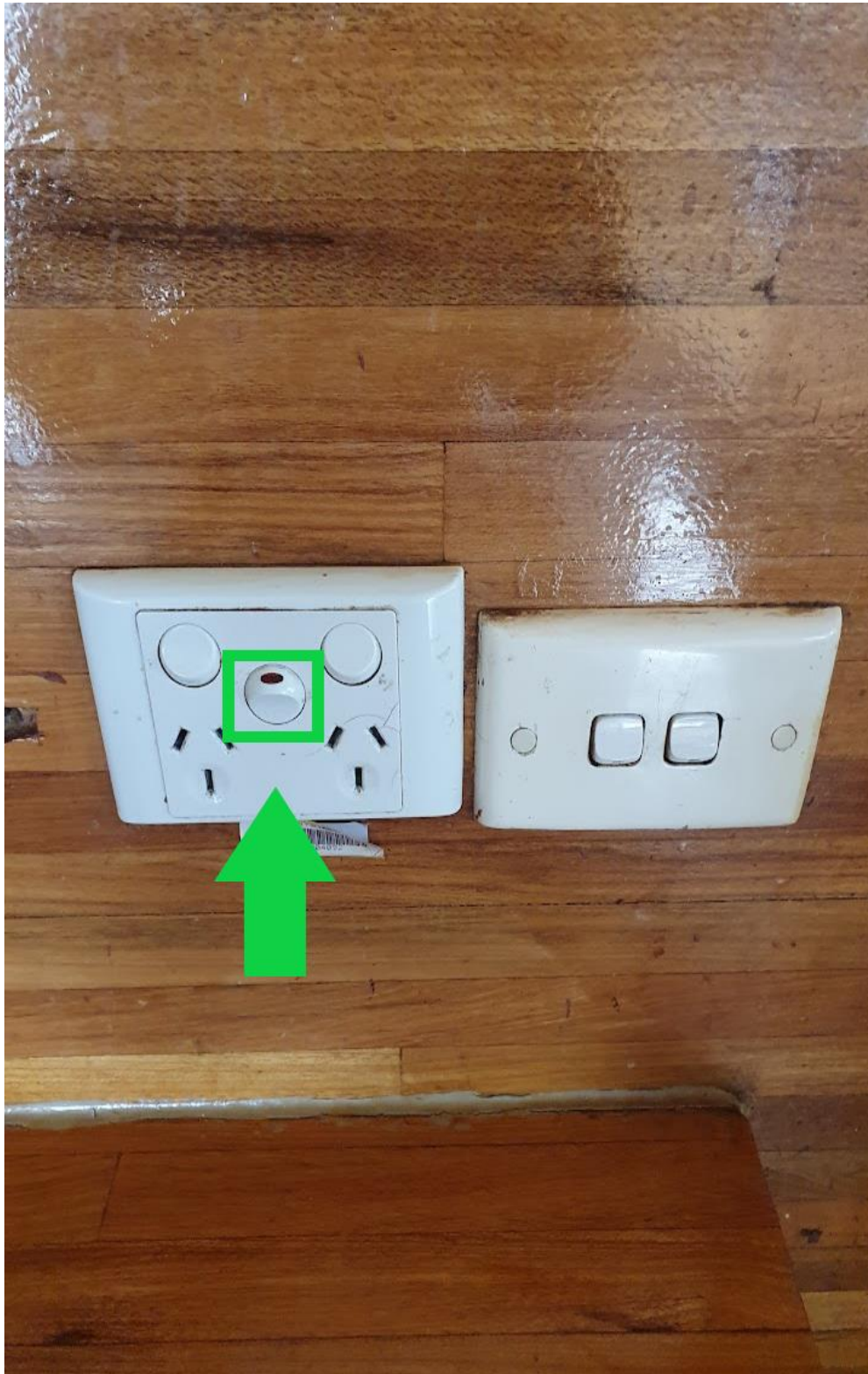

Game Room Lights

Pool Room Down Lights:

Top and bottom switch on frame beside bifold doors; top must be on bottom off for both lights to work.



Game Room Fireplace Area:

Pull cord light switch



Courtyard Fairy Lights

Part 1/2:

Pull cord light switch



Part 2/2:

On door entry door frame in room 7



Laundry Lights

Part 1/2:

On door frame to entry/exit the laundry to veranda



Part 2/2:

On door frame to enter the dining hall



Entrance Veranda Fluorescent Lights

Part 1/2:

There are two on/off options available

Top switch on kitchen door frame next to dishwasher



Part 2/2:

There are two on/off options available

On wall after the vine covered entrance to the veranda, near the cabin floodlights, and opposite the carpark fire hose.



Carpark Veranda Floodlights

Part 1/2:

There are two on/off options available

On internal door frame at the emergency exit



Part 2/2:

There are two on/off options available

On exterior door frame at the emergency exit

